

2/2-way Diaphragm Valve with stainless steel design, welded or clamp connection, DN 4-50

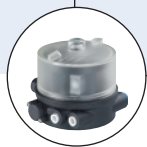

- Hermetical separation of fluids from the operating mechanism by diaphragm
- Zero dead volume
- Various surface finishes
- Certified according to FDA
- Clean design for optimal use in hygienic environment

Type 2103 cast On/Off can be combined with...



Type 8690

Pneum. control unit with feedback



Type 8691

Control Head



Type 8695

Control Head

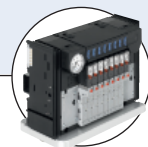

Type 8644

Automation system AirLINE



Type 8110

Level meter

The externally piloted diaphragm valve consists of a pneumatically operated piston actuator, a diaphragm and a 2-way valve housing made of cast stainless steel. The high-quality actuator with a stainless steel cover is designed for usage in hygienic or aggressive environments.

The flow optimised and zero dead volume valve body makes high flow rates possible and a variety of applications to be realised.

The design enables the easy integration of automation modules whether they are electrical/optical position feedback, pneumatic control units, an integrated fieldbus interface or even an explosion proof feedback.

The fully integrated system has a compact and smooth design, integrated pneumatic lines, IP65/67/NEMA4X protection class and superior chemical resistance.

Technical data	
Orifice	DN 4 to 50
Body material	Cast stainless steel 316L / 1.4435
Actuator material	PPS / Stainless steel 1.4561 (316Ti)
Actuator / Cover	
Diaphragm materials	EPDM, PTFE/EPDM (advanced PTFE/EPDM, FKM on request)
Media	Neutral gases and liquids, high purity, sterile, aggressive or abrasive fluids
Viscosity	up to viscous
Surface finishes	(average surface finish)
internal mechanical polished	Ra ≤ 0.8 µm (external cast surface)
internal electro polished (on request)	Ra ≤ 0.6 µm (external cast surface electro polished)
internal mechanical polished (on request)	Ra ≤ 0.25 µm
Medium temperatures	
EPDM, PTFE/EPDM, advanced PTFE/EPDM (on request) ¹⁾	-10 to +130°C (briefly up to +150°C for steam sterilisation)
FKM on request	-10 to +130°C
Ambient temperature	+5 to +60°C
Control medium	Neutral gases, air
Max. pilot pressure	max. 10 bar, 7 bar with actuator size 130 mm
Port connections	
Weld end	<ul style="list-style-type: none"> ▪ DIN EN ISO 1127 / ISO 4200 / DIN 11866 Series B ▪ DIN 11850 Series 2 / DIN 11866 Series A ▪ DIN 11850 Series 0 ▪ SMS 3008 (on request) ▪ DIN 32676 Series A (DIN Tube) ▪ BS4825/ASME BPE ▪ ISO 2852 / SMS 3017 (on request)
Clamp	
Pilot air ports	Push-in connector for external ø 6 mm or 1/4" tube, thread G1/8 (on request)
Installation	as required, preferably with actuator in upright position

¹⁾ Advanced PTFE/EPDM is recommended for sterilization cycle

Content



Valve specifications

Type 2103 cast On/Off

Technical data & ordering info.

p. 1-8



System spec. On/Off ELEMENT

Type 8801-DF

Ordering info. & technical data

p. 9-13

Request for quotation

Type 8801-DF

p. 13

Technical data valves

Kv-value

Orifice		Kv value water (m ³ /h)	Actuator size Ø [mm]	Permitted pilot pressure [bar]		Max. operating pressure [bar] for seal material	
[mm]	[inch]			min.	max.	EPDM, FKM [bar]	PTFE/EPDM and ad- vanced PTFE/EPDM [bar]
4	-	0.8	50	5	10	10	10
6	-	0.8	50	5	10	10	10
8	1/4"	1.0	50	5	10	10	10
10	3/8"	1.0	50	5	10	10	10
15	1/2"	5.5	70	5	10	10	10
20	3/4"	10.0	70	5	10	10	10
25	1"	14.0	70	5	10	6.5	6
			90	5.5	10	10	8
40	1 1/2"	30.0	130	5.0	7	10	10
50	2"	51.5	130	5.0	7	8	7

Flow rate: Kv value water [m³/h]: Measured at +20°C, 1 bar pressure at valve inlet and free outlet.

Pressure valves [bar]: Overpressure to the atmospheric pressure

Installation for self-draining operation

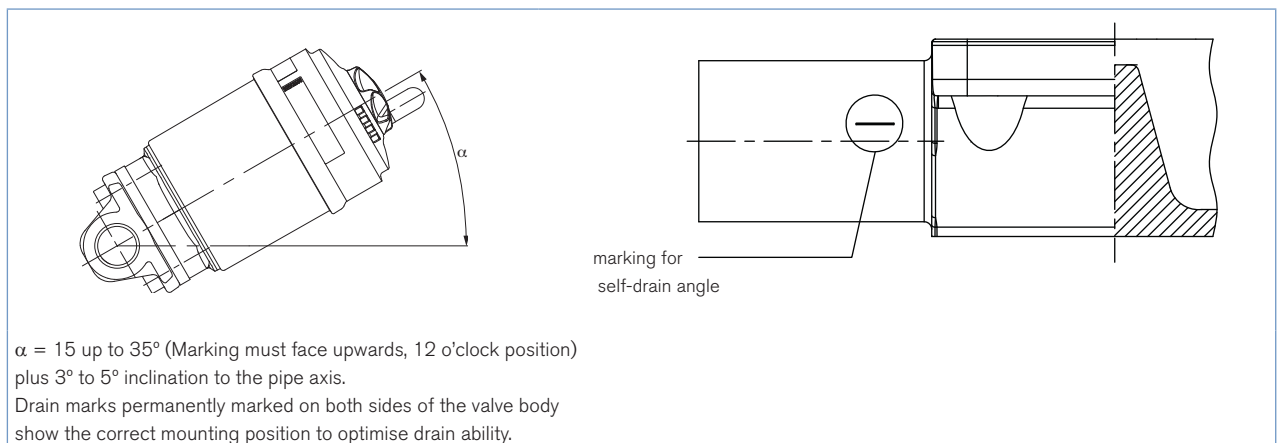

Approvals

Suitability for foodstuffs / sterile applications



- The composition of the EPDM, PTFE/EPDM and advanced PTFE/EPDM diaphragms corresponds to the *Code of Federal Regulations, published by the FDA* (Food and Drug Administration, USA).
- The EPDM diaphragms correspond to the KTW Recommendation (Plastics in the Drinking Water Sector). A Manufacturer's Declaration will be supplied on request.

Materials

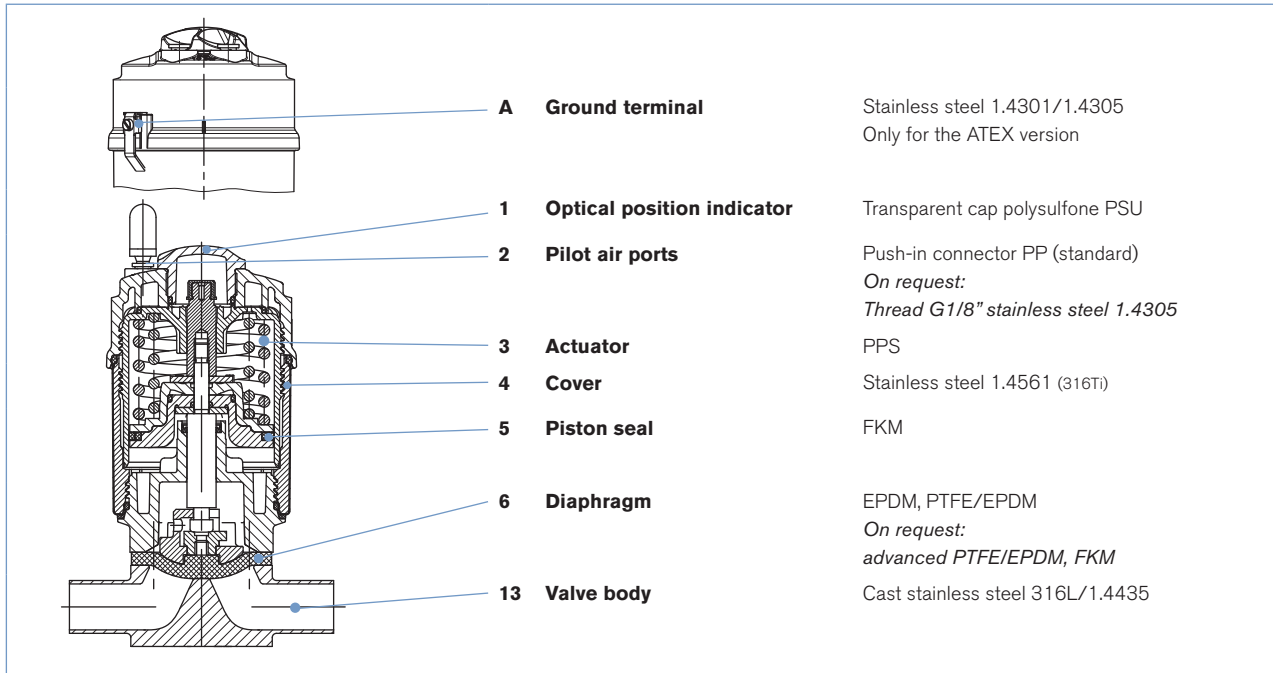

Ordering chart Type 2103 cast diaphragm valve

Welded connection, surface finish mechanical polished, Ra ≤ 0.8 μm, further on request

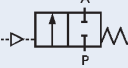
Control function	Orifice		External-Ø [mm]	Kv value water (m³/h)	Actuator size Ø [mm]	Pilot pressure [bar]	Max. operating pressure [bar]	Item no. mechanical polished, Ra \leq 0.8 μm
	[mm]	[inch]						
A 2/2-way valve, normally closed (NC) 	Acc. to EN ISO 1127/ISO 4200/DIN 11866 Series B							
	Diaphragm material EPDM							
	8	1/4"	13.5	1.0	50	5-10	10	187 239
	15	1/2"	21.3	5.5	70	5-10	10	175 128
	20	3/4"	26.9	10.0	70	5-10	10	175 129
	25	1"	33.7	14.0	70	5-10	6.5	175 131
					90	5.5-10	10	180 345
	40	1 1/2"	48.3	30.0	130	5-7	10	188 360
	50	2"	60.3	51.5	130	5-7	8	188 367
	Diaphragm material PTFE/EPDM							
	8	1/4"	13.5	1.0	50	5-10	10	187 240
	15	1/2"	21.3	5.5	70	5-10	10	175 132
	20	3/4"	26.9	10.0	70	5-10	10	175 133
	25	1"	33.7	14.0	70	5-10	6	175 134
					90	5.5-10	8	180 346
	40	1 1/2"	48.3	30.0	130	5-7	10	219 312
	50	2"	60.3	51.5	130	5-7	7	219 313
	Acc. to DIN 11850 Series 2/ DIN 11866 Series A							
	Diaphragm material EPDM							
	10	3/8"	13	1.0	50	5-10	10	187 243
	15	1/2"	19	5.5	70	5-10	10	176 556
	20	3/4"	23	10.0	70	5-10	10	176 557
	25	1"	29	14.0	70	5-10	6.5	176 558
					90	5.5-10	10	180 349
	40	1 1/2"	41.0	30.0	130	5-7	10	188 372
	50	2"	53.0	51.5	130	5-7	8	188 373
	Diaphragm material PTFE/EPDM							
	10	3/8"	13	1.0	50	5-10	10	187 244
	15	1/2"	19	5.5	70	5-10	10	176 559
	20	3/4"	23	10.0	70	5-10	10	176 560
25	1"	29	14.0	70	5-10	6	176 561	
				90	5.5-10	8	180 350	
40	1 1/2"	41.0	30.0	130	5-7	10	188 374	
50	2"	53.0	51.5	130	5-7	7	188 375	
Acc. to DIN 11850 Series 0								
Diaphragm material EPDM								
4	-	6	0.8	50	5-10	10	187 255	
6	-	8	0.8	500	5-10	10	187 256	
Diaphragm material PTFE/EPDM								
4	-	6	0.8	50	5-10	10	187 257	
6	-	8	0.8	50	5-10	10	187 258	

Further versions on request

**Material**

Seal: advanced PTFE/EPDM, FKM

**Port connection**

Welded acc. SMS 3008

**Control function**

B (normally open) and I (double-acting)

**Additional**

Surface finishes ≤ 0.6 and further

Ordering chart Type 2103 cast diaphragm valve, continued

Clamp connection, surface finish mechanical polished, $Ra \leq 0.8 \mu\text{m}$, further on request

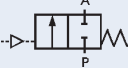
Control function	Orifice		External-Ø [mm]	Kv-value water [m³/h]	Actuator size Ø [mm]	Pilot pressure [bar]	Max. operating pressure [bar]	Item no. mechanical polished, $Ra \leq 0.6 \mu\text{m}$
	[mm]	[inch]						
A 2/2-way valve, normally closed (NC) 	Acc. to DIN 32676 Series A							
	Diaphragm material EPDM							
	15	1/2"	34.0	5.5	70	5-10	10	188 479
	20	3/4"	34.0	10.0	70	5-10	10	188 480
	25	1"	50.5	14.0	70	5-10	6.5	188 481
					90	5.5-10	10	188 482
	40	1 1/2"	50.5	30.0	130	5-7	10	188 483
	50	2"	64.0	51.5	130	5-7	8	188 484
	Diaphragm material PTFE/EPDM							
	15	1/2"	34.0	5.5	70	5-10	10	188 485
	20	3/4"	34.0	10.0	70	5-10	10	188 486
	25	1"	50.5	14.0	70	5-10	6	188 487
					90	5.5-10	8	188 488
	40	1 1/2"	50.5	30.0	130	5-7	10	188 489
	50	2"	64.0	51.5	130	5-7	7	188 490
	Acc. to BS 4825/ASME BPE							
	Diaphragm material EPDM							
	8	1/4"	25.0	1.0	50	5-10	10	187 279
	10	3/8"	25.0	1.0	50	5-10	10	187 280
	15	1/2"	25.0	5.5	70	5-10	10	188 527
	25	1"	50.5	14.0	70	5-10	6.5	188 528
					90	5.5-10	10	188 529
	40	1 1/2"	50.5	30.0	130	5-7	10	188 530
	50	2"	64	51.5	130	5-7	8	188 531
	Diaphragm material PTFE/EPDM							
	8	1/4"	25.0	1.0	50	5-10	10	187 281
	10	3/8"	25.0	1.0	50	5-10	10	187 282
	15	1/2"	25.0	5.5	70	5-10	10	188 532
25	1"	50.5	14.0	70	5-10	6	188 533	
				90	5.5-10	8	188 534	
40	1 1/2"	50.5	30.0	130	5-7	10	188 535	
50	2"	64	51.5	130	5-7	7	188 536	

 **Further versions on request**
**Material**

Seal: advanced PTFE/EPDM, FKM

**Port connection**

Clamp acc. to ISO 2852/SMS 3017

**Control function**

B (normally open) and I (double-acting)

**Additional**Surface finishes ≤ 0.6 and further

Dimensions Type 2103 cast diaphragm valve [mm]

Welded connection

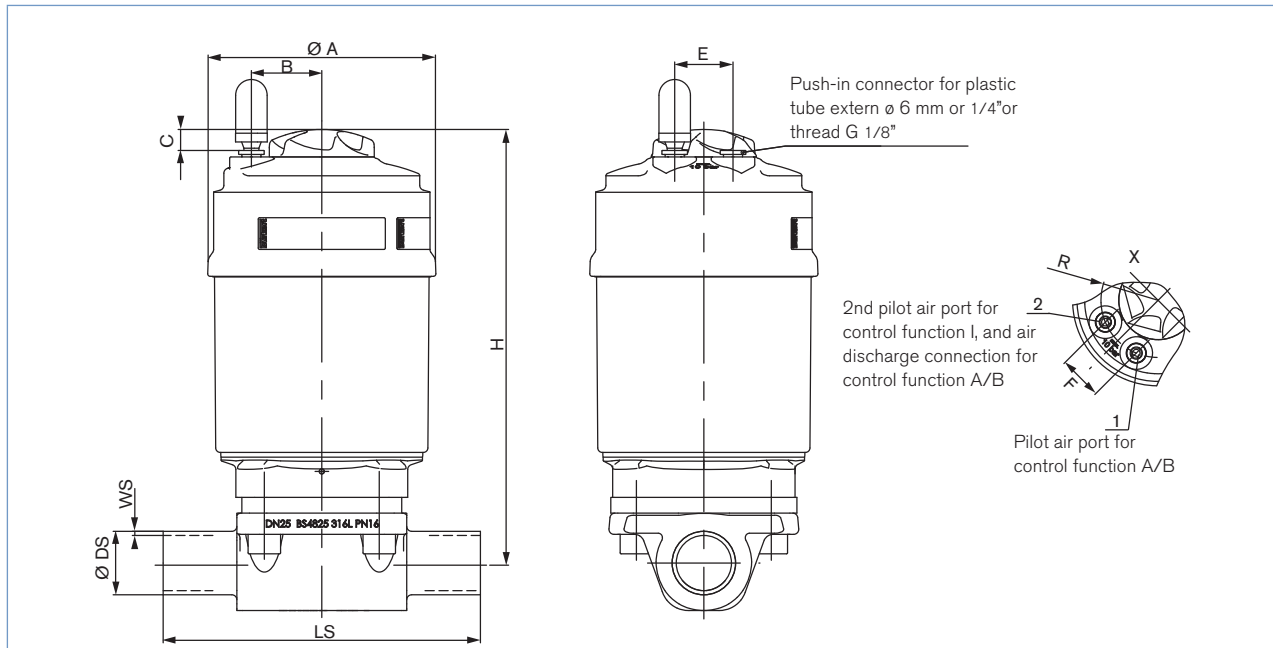

EN ISO 1127/ISO 4200/DIN 11866 Series B and DIN 11850 Series 2/ DIN 11866 Series A

All bodies											EN ISO 1127/ ISO 4200/ DIN 11866 S. B		DIN 11850 S. 2/ DIN 11866 S. A	
Orifice		Actuator size Ø	Ø A	B	F	C	R	E	H	LS	Ø DS	WS	Ø DS	WS
[mm]	[inch]	[mm]												
8	1/4"	50	64.5	17.15	19.8	6.1	17.15	19.8	129	90	13.5	1.6	-	-
10	3/8"	50	64.5	17.15	19.8	6.1	17.15	19.8	144	110	17.2	1.6	13.0	1.5
15	1/2"	70	91	30.5	23.3	8.5	30.5	23.3	161	110	21.3	1.6	19.0	1.5
20	3/4"	70	91	30.5	23.3	8.5	30.5	23.3	171	119	26.9	1.6	23.0	1.5
25	1"	70	91	30.5	23.3	8.5	30.5	23.3	174	129	33.7	2.0	29.0	1.5
		90	120	30.5	23.3	8.5	30.5	23.3	207	129	33.7	2.0	29.0	1.5
40	1 1/2"	130	159	30.5	23.3	8.5	30.5	23.5	288	161	48.3	2.0	41.0	1.5
50	2"	130	159	30.5	23.3	8.5	30.5	23.5	311	192	60.3	2.0	53.0	1.5

DIN 11850 Series 0

Orifice [mm]	Actuator size Ø [mm]	Ø A	B	F	C	R	E	H	LS	Ø DS	WS
4	50	64.5	17.15	19.8	6.1	17.15	19.8	129	90	6	1.0
6	50	64.5	17.15	19.8	6.1	17.15	19.8	129	90	8	1.0

On request: SMS 3008

Orifice [mm]	[inch]	Actuator size Ø [mm]	Ø A	B	F	C	R	E	H	LS	Ø DS	WS
25	1"	70	91	30.5	23.3	8.5	30.5	23.3	174	127	25	1.2
		90	120	30.5	23.3	8.5	30.5	23.3	207	127	25	1.2

Dimensions Type 2103 cast diaphragm valve [mm], *continued*

Clamp connection

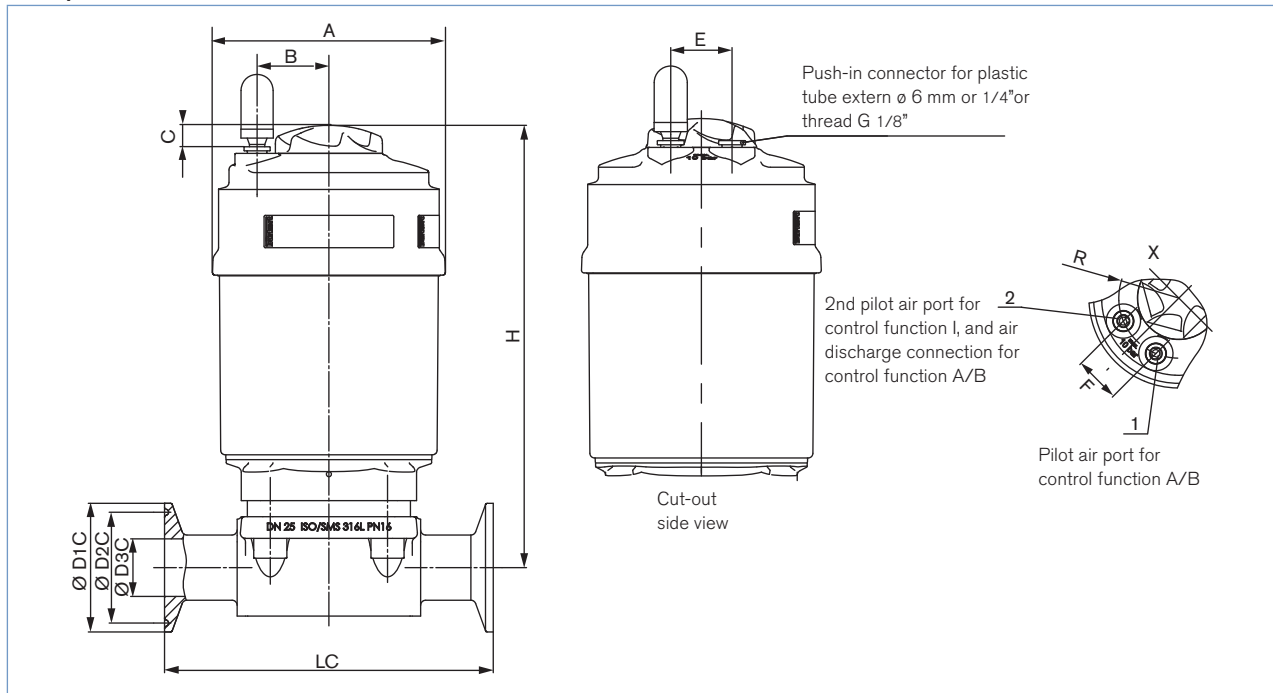

DIN 32676 Series A and BS 4825/ASME PBE

All bodies											DIN 32676 S. A				BS 4825/ASME PBE			
Orifice		Actuator size Ø	Ø A	B	F	C	R	E	H	LC	Ø D1C	Ø D2C	Ø D3C	LC	Ø D1C	Ø D2C	Ø D3C	
[mm]	[inch]																	
8	1/4"	50	64.5	17.15	19.8	6.1	17.15	19.8	129	-	-	-	-	89	25	20.22	7.1	
10	3/8"	50	64.5	17.15	19.8	6.1	17.15	19.8	144	-	-	-	-	89	25	20.22	10.3	
15	1/2"	70	91	30.5	23.3	8.5	30.5	23.3	161	110	34	27.5	16	102	25	20.22	16.7	
20	3/4"	70	91	30.5	23.3	8.5	30.5	23.3	171	119	34	27.5	20	-	-	-	-	
25	1"	70	91	30.5	23.3	8.5	30.5	23.3	174	129	50.5	43.5	26	114	20.5	43.5	22.2	
		90	120	30.5	23.3	8.5	30.5	23.3	207	129	50.5	43.5	26	114	50.5	43.5	22.2	
40	1 1/2"	130	159	30.5	23.3	8.5	30.5	23.5	288	161	50.5	43.5	38	140	50.5	43.5	34.9	
50	2"	130	159	30.5	23.3	8.5	30.5	23.5	311	192	64	56.5	50	159	64	56.5	47.6	

On request: ISO 2852/SMS 3017

Orifice		Actuator size Ø	Ø A	B	F	C	R	E	H	LC	Ø D1C	Ø D2C	Ø D3C
[mm]	[inch]												
25	1"	70	91	30.5	23.3	8.5	30.5	23.3	174	129	50.5	43.5	22.6
		90	120	30.5	23.3	8.5	30.5	23.3	207	129	50.5	43.5	22.6

Ordering information for valve system On/Off ELEMENT Type 8801-DF

A valve system On/Off ELEMENT Type 8801-DF consists of a diaphragm valve Type 2103 and a pneumatic control unit Type 8690 or control head Type 8691 (for valve actuator sizes $\varnothing 70/\varnothing 90/\varnothing 130$ mm) or control head Type 8695 (for valve actuator size $\varnothing 50$ mm) (see separate datasheets). For the configuration of further valve systems please use the "Request for quotation" on p. 13 [go to page](#)

You order two components and receive a complete assembled and certified valve.

Ordering the valve system On/Off ELEMENT Type 8801-DF with valve actuator sizes $\varnothing 70/\varnothing 90/\varnothing 130$ mm

Diaphragm valve Type 2103

with actuator size $\varnothing 70/\varnothing 90/\varnothing 130$ mm

Control unit



Pneum. control unit
Type 8690



Control head
Type 8691

Diaphragm valve with desired control unit



Valve system
On/Off ELEMENT
Type 8801-DF-K
Type 2103 + 8690



Valve system
On/Off ELEMENT
Type 8801-DF-H
Type 2103 + 8691

Click on the orange box "More info." below... you will come to our website for the resp. product where you can download the data sheet.

Pneumatic control unit Type 8690



More
info.

The new generation of integrated controllers for combination with actuators from the process valve series Type 21xx is specially designed for the requirements of hygienic process environments.

The pneumatic control unit Type 8690 combines electrical position feedback and pneumatic control for single or double-acting actuators, and is also optionally available as an intrinsically safe model to ATEX.

Main customer benefits:

- Compact design of the valve system with integrated controller meets the demands for plant washdown environments through the selection of materials, external seals and integrated control air supply to the actuator.
- Integrated pilot valve with manual actuation
- Air intake filter enhances the process valve system availability
- Simple and reliable actuator adaptations allowing additional actuators of the process valve series, Type 20xx or actuators from other manufacturers to be used

Control head Type 8691



More
info.

The new generation of integrated control heads for combination with actuators from the process valve series Type 21xx is specially designed for the requirements of hygienic process environments.

The intelligent control head, Type 8691, detects the valve position by means of a contact-free analog position sensor circumventing excessive wear of mechanical parts. Single or double-acting actuators are controlled via the integral pilot valve. Communication interfaces AS-Interface and DeviceNet are available as options.

Main customer benefits:

- Compact, hygienic design of the valve system with integrated controller meets the demands of plant washdown environments through the selection of materials, external seals and integrated control air supply to the actuator.
- Automatic setting of the control head at the push of a button
- Even under dirty or dark environments, a clearly visible status display due to powerful LEDs
- Monitoring and diagnosis: Process valve systems with field bus interface used in modern plant processes
- Integrated pilot valve with manual actuation
- Air intake filter enhances the process valve system availability
- Simple and reliable actuator adaptations allowing additional actuators of the process valve series, Type 20xx or actuators from other manufacturers to be used

Ordering information for valve system On/Off ELEMENT Type 8801-DF, continued

A valve system On/Off ELEMENT Type 8801-DF consists of a diaphragm valve Type 2103 and a pneumatic control unit Type 8690 or control head Type 8691 (for valve actuator sizes $\varnothing 70/\varnothing 90/\varnothing 130$ mm) or control head Type 8695 (for valve actuator size $\varnothing 50$ mm) (see separate datasheets). For the configuration of further valve systems please use the "Request for quotation" on p. 13 [go to page](#)

You order two components and receive a complete assembled and certified valve.

Ordering the valve system On/Off ELEMENT Type 8801-DF with valve actuator sizes $\varnothing 50$ mm

**Diaphragm valve Type 2103
with actuator size $\varnothing 50$ mm**



Control unit



Control head
Type 8695

**Diaphragm valve with
desired control unit**



**Valve system
On/Off ELEMENT
Type 8801-DF-M
Type 2103 + 8695**

Click on the orange box "More info." below... you will come to our website for the resp. product where you can download the data sheet.

Control head Type 8695



**More
info.**

The new generation of integrated control heads for combination with small actuators from the process valve series Type 21xx is specially designed for the requirements of hygienic process environments. The intelligent control head, Type 8695, detects the valve position by means of a contact-free analog position sensor circumventing excessive wear of mechanical parts. Single and double-acting actuators are controlled via the integral pilot valve. An AS-Interface communication interface is available as an option.

Main customer benefits:

- Compact, hygienic design of the valve system with integrated controller meets the demands of plant washdown environments through the selection of materials, external seals and integrated control air supply to the actuator
- Automatic setting of the control head at the push of a button
- Visual status display on the control head
- Monitoring and diagnosis: Process valve systems with fieldbus interface used in modern plant processes
- Integrated pilot valve
- Simple and reliable actuator adaption

Dimensions for valve system On/Off ELEMENT Type 8801-DF [mm]

Dimensions valve system On/Off ELEMENT Type 8801-DF-K (with pneumatic control unit Type 8690) [mm]

Welded connection

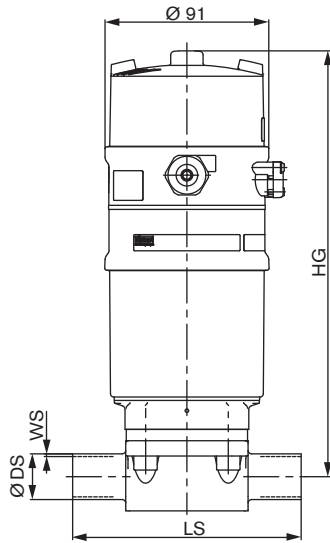

EN ISO 1127/ISO 4200/DIN 11866 S. B and DIN 11850 S. 2/DIN 11866 S. A (SMS 3008 on request)

Orifice		Actuator size Ø			EN ISO 1127/ ISO 4200/ DIN 11866 S. B		DIN 11850 S. 2/ DIN 11866 S. A		SMS 3008 (on request)	
[mm]	[inch]	[mm]	HG	LS	Ø DS	WS	Ø DS	WS	Ø DS	WS
15	1/2"	70	224	110	21.3	1.6	19	1.5	-	-
20	3/4"	70	234	119	26.9	1.6	23	1.5	-	-
25	1"	70	237	129	33.7	2.0	29	1.5	25	1.2
		90	270	129	33.7	2.0	29	1.5	25	1.2
40	1 1/2"	130	351	161	48.3	2.0	41	1.5	38	1.2
50	2	130	374	192	60.3	2.0	53	1.5	51	1.2

Clamp connection

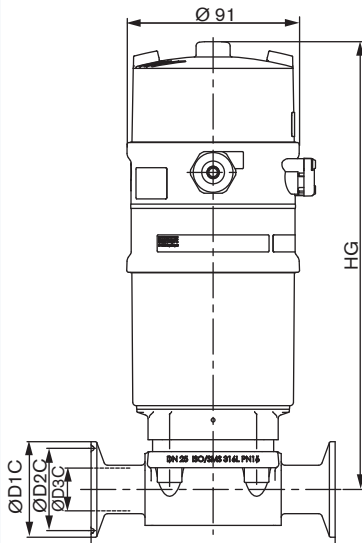

DIN 32676 Series A and BS 4825/ASME BPE

Orifice		Actuator size Ø	DIN 32676 S. A			BS 4825/ASME BPE					
[mm]	[inch]	[mm]	HG	LC	Ø D1C	Ø D2C	Ø D3C	LC	Ø D1C	Ø D2C	Ø D3C
15	1/2"	70	224	110	34	27.5	16	102	25	20.22	16.7
20	3/4"	70	234	119	34	27.5	20	-	-	-	-
25	1"	70	237	129	50.5	43.5	26	114	50.5	43.5	22.2
		90	270	129	50.5	43.5	26	114	50.5	43.5	22.2
40	1 1/2"	130	351	161	50.5	43.5	38	140	50.5	43.5	34.9
50	2	130	374	192	64.0	56.5	50	159	64	56.5	47.6

On request: ISO 2852/SMS 3017

Orifice		Actuator size Ø					
[mm]	[inch]	[mm]	HG	LC	Ø D1C	Ø D2C	Ø D3C
25	1"	70	237	129	50.5	43.5	22.6
		90	270	129	50.5	43.5	22.6

Dimensions for valve system On/Off ELEMENT Type 8801-DF [mm], *continued*

Dimensions valve system On/Off ELEMENT Type 8801-DF-H (with control head Type 8691) [mm]

Welded connection

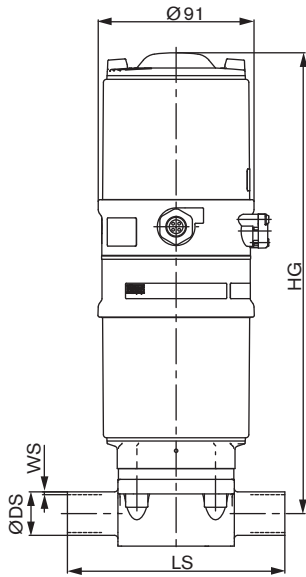

EN ISO 1127/ISO 4200/DIN 11866 S. B and DIN 11850 S. 2/DIN 11866 S. A (SMS 3008 on request)

Orifice		Actuator size Ø			EN ISO 1127/ ISO 4200/ DIN 11866 S. B		DIN 11850 S. 2/ DIN 11866 S. A		SMS 3008 (on request)	
[mm]	[inch]	[mm]	HG	LS	Ø DS	WS	Ø DS	WS	Ø DS	WS
15	1/2"	70	257	110	21.3	1.6	19	1.5	-	-
20	3/4"	70	267	119	26.9	1.6	23	1.5	-	-
25	1"	70	1270	129	33.7	2.0	29	1.5	25	1.2
		90	303	129	33.7	2.0	29	1.5	25	1.2
40	1 1/2"	130	384	161	48.3	2.0	41	1.5	38	1.2
50	2	130	407	192	60.3	2.0	53	1.5	51	1.2

Clamp connection

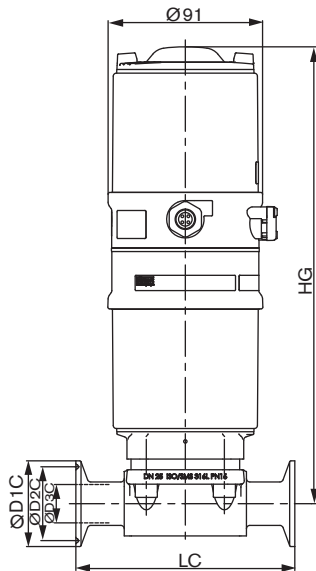

DIN 32676 Series A and BS 4825/ASME BPE

Orifice		Actuator size Ø			DIN 32676 S. A			BS 4825/ASME BPE			
[mm]	[inch]	[mm]	HG	LC	Ø D1C	Ø D2C	Ø D3C	LC	Ø D1C	Ø D2C	Ø D3C
15	1/2"	70	257	110	34	27.5	16	102	25	20.22	16.7
20	3/4"	70	267	119	34	27.5	20	-	-	-	-
25	1"	70	1270	129	50.5	43.5	26	114	50.5	43.5	22.2
		90	303	129	50.5	43.5	26	114	50.5	43.5	22.2
40	1 1/2"	130	384	161	50.5	43.5	38	140	50.5	43.5	34.9
50	2	130	407	192	64.0	56.5	50	159	64	56.5	47.6

On request: ISO 2852/SMS 3017

Orifice		Actuator size Ø					
[mm]	[inch]	[mm]	HG	LC	Ø D1C	Ø D2C	Ø D3C
25	1"	70	270	129	50.5	43.5	22.6
		90	303	129	50.5	43.5	22.6

Dimensions for valve system On/Off ELEMENT Type 8801-DF [mm], *continued*

Dimensions valve system On/Off ELEMENT Type 8801-DF-M (with control head Type 8695) [mm]

Welded connection

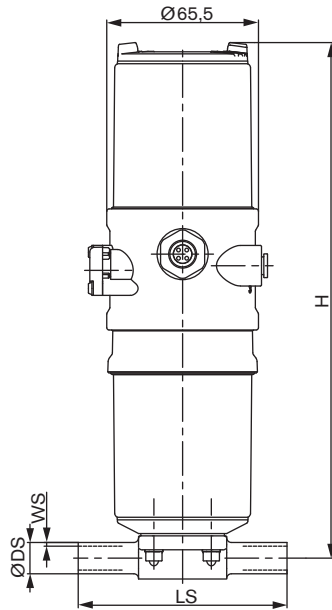

EN ISO 1127/ISO 4200/DIN 11866 Series B and DIN 11850 Series 2/DIN 11866 Series A

Orifice		Actuator size Ø [mm]	H	LS	EN ISO 1127/ ISO 4200/ DIN 11866 S. B		DIN 11850 S. 2/ DIN 11866 S. A	
[mm]	[inch]				Ø DS	WS	Ø DS	WS
08	1/4"	50	223	90	13.5	1.6	-	-
10	3/8"	50	223	90	17.2	1.6	13.0	1.5

DIN 11850 Series 0

Orifice		Actuator size Ø [mm]	H	LS	Ø DS	WS
[mm]	[inch]					
04	-	50	223	90	6	1.0
06	-	50	223	90	8	1.0

Clamp connection

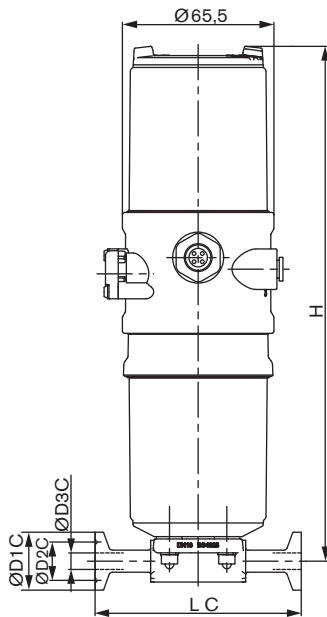

BS 4825

Orifice		Actuator size Ø [mm]	HG	LC	BS 4825		
[mm]	[inch]				Ø D1C	Ø D2C	Ø D3C
8	1/4"	50	223	89	25	20.22	7.1
10	3/8"	50	223	89	25	20.22	10.3

Valve features, specification key - Request for quotation

Example

2103 A 15 AB VG SA42 NO06

Specification key

(Please make a choice)

CONTROL FUNCTION

A	normally closed by spring action
B	normally open by spring action
I	double acting

ORIFICE [mm] (diaphragm)

04
06
08
10
15
20
25
32
40
50

SEAL MATERIAL

AB	EPDM in food quality
EA	PTFE/EPDM
FF	FKM
EU	advanced PTFE/EPDM in two pieces
ET	advanced PTFE (bonded on EPDM)

BODY MATERIAL

VG	Cast stainless steel 316L/1,4435
----	----------------------------------

VARIABLE CODES

NO06	Int. Mechanical polished Ra=0.8µm
NO18	Int. Mechanical polished Ra=1.6µm
NO16	Int. Electro polished Ra=0.6µm

Standard



DN [mm]	Port connection weld end							
	EN ISO 1127/ ISO 4200 DIN 11866 S. B	SMS 3008	DIN 11850 S. 0	DIN 11850 S. 1	DIN 11850 S. 2 DIN 11866 S. A	DIN 11850 S. 3	BS4825	ASME BPE DIN 11866 S. C
4			SC40 - 6.0x1.0					
6	SA78 - 10.2x1.6		SC41 - 8.0x1.0					SA89 - 3.17x0.56
8	SA40 - 13.5x1.6		SC42 - 10.0x1.0				SODB - 6.35x1.2	SA90 - 6.35x0.89
10	SA41 - 17.2x1.6			SF40 - 12.0x1.0	SD40 - 13.0x1.5	SE40 - 14.0x2.0	SODC - 9.53x1.2	SA91 - 9.53x0.89
15	SA42 - 21.3x1.6	SA58 - 12.0x1.0	SC43 - 18.0x1.5	SF41 - 18.0x1.0	SD42 - 19.0x1.5	SE42 - 20.0x2.0	SODD - 12.7x1.2	SA92 - 12.7x1.65
20	SA43 - 26.9x1.6	SA59 - 18.0x1.0	SC44 - 22.0x1.5	SF42 - 22.0x1.0	SD43 - 23.0x1.5	SE43 - 24.0x2.0	SODE - 19.05x1.2	SA93 - 19.05x1.65
25	SA44 - 33.7x2.0	SA60 - 25.0x1.2	SC45 - 28.0x1.5	SF43 - 28.0x1.0	SD44 - 29.0x1.5	SE44 - 30.0x2.0		SODF - 25.4x1.65
32	SA45 - 42.4x2.0	SA61 - 33.7x1.2	SC46 - 34.0x1.5	SF44 - 34.0x1.0	SD45 - 35.0x1.5	SE45 - 36.0x2.0		
40	SA46 - 48.3x2.0	SA62 - 38.0x1.2	SC47 - 40.0x1.5	SF45 - 40.0x1.0	SD46 - 41.0x1.5	SE46 - 42.0x2.0		SODH - 38.1x1.65
50	SA47 - 60.3x2.0	SA63 - 51.0x1.2	SC48 - 52.0x1.5	SF46 - 52.0x1.0	SD47 - 53.0x1.5	SE47 - 54.0x2.0		SODI - 50.8x1.65

DN [mm]	Port connection Clamp				
	Clamp 34,0 like DIN 32676 S. B (ISO-tube (ISO4200))	DIN 32676 S. A (DIN-tube (DIN11850))	DIN 32676 S. B (ISO-tube (ISO4200))	ASME BPE	BS 4825 (Clamp BS 4825-3, tube BS 4825-1)
8	TC51 - 13.5x1.6 Ci: 34.0	TD40 - 10.0x1.0 Ci: 25.0	TC40 - 13.5x1.6 Ci: 25.0	TG50 - 6.35x0.89 Ci: 25.0	
10	TC41 - 17.2x1.6 Ci: 34.0	TD41 - 13.0x1.5 Ci: 34.0	TC53 - 17.2x1.6 Ci: 25.0	TG01 - 9.53x0.89 Ci: 25.0	
15	TC42 - 21.3x1.6 Ci: 34.0	TD42 - 19.0x1.5 Ci: 34.0	TC52 - 21.3x1.6 Ci: 50.5	TG02 - 12.7x1.65 Ci: 25.0	TH42 - 12.7x1.2 Ci: 25.0
20		TD43 - 23.0x1.5 Ci: 34.0	TC43 - 26.9x1.6 Ci: 50.5	TG03 - 19.05x1.65 Ci: 25.0	TH43 - 19.05x1.2 Ci: 25.0
25		TD44 - 29.0x1.5 Ci: 50.5	TC44 - 33.7x2.0 Ci: 50.5	TG04 - 25.4x1.65 Ci: 50.5	
40		TD46 - 41.0x1.5 Ci: 50.5	TC46 - 48.3x2.0 Ci: 64.0	TG05 - 38.1x1.65 Ci: 50.5	
50		TD47 - 53.0x1.5 Ci: 64.0	TC47 - 60.3x2.0 Ci: 77.5	TG06 - 50.8x1.65 Ci: 64.0	

Note
You can fill out the fields directly in the PDF file before printing out the form.

Valve system On/Off ELEMENT Type 8801-DF – request for quotation

▶ Please fill out and send to your nearest Bürkert facility with your inquiry or order

Company	Contact person
Customer no.	Department
Address	Tel./Fax
Postcode/town	E-Mail

= mandatory fields to fill out Quantity Required delivery date

Operating data

Pipe line DN PN

Pipe material

Process medium

Type of media Liquid Steam Gas

Valve features

Specification key

2103

(automatically transferred from p 13)

Surface finish (if not standard) internal µm external µm

Pilot pressure min. max.

Atex II 2GD Mechanical

Control unit features

Click on the orange box „More info.“ below... you will come to our website for the resp. product where you can download the data sheet.

For actuator sizes ø70/ø90/ø130 mm

Pneumatic Control Unit Type 8690 **More info.**

Pneumatic function

Single-acting Double-acting

Without pilot valve

Position feedback

1x inductive 2x inductive

1x inductive (NAMUR) 2x inductive (NAMUR)

1x mechanical 2x mechanical

Supply voltage

24V DC (ATEX Zone 2/22)

Ex ia IIC T6 (ATEX Zone 1)

Pilot air ports

Push-in connector external ø 6 mm or 1/4"

Thread G 1/8"

Please specify item no. (if known):

Control Head Type 8691 **More info.**

Pneumatic function

Single-acting Double-acting

Pilot air ports

Push-in connector external ø 6 mm or 1/4"

Thread G 1/8"

Communication

ASI

Multipol M12

Flat cable clip, 1 m cable

DeviceNet

Please specify item no. (if known):

For actuator sizes ø50 mm

Control Head Type 8695 **More info.**

Pneumatic function

Single-acting Double-acting

Pilot air ports

Push-in connector external ø 6 mm or 1/4"

Thread G 1/8"

Communication

ASI

Please specify item no. (if known):

continued on next page →

Valve system On/Off Classic Type 8801-DF – request for quotation, *continued.*

Control unit features, <i>continued</i>							
<table border="1"> <thead> <tr> <th>Pilot valve</th> <th>Control Stroke limitation</th> </tr> </thead> <tbody> <tr> <td> <input type="checkbox"/> Pilot valve Power supply <input type="text"/> </td> <td> <input type="checkbox"/> Stroke limitation <input type="checkbox"/> Min./max. stroke with visual position indicator <input type="checkbox"/> Max. stroke without visual position indicator </td> </tr> <tr> <td> Please specify item no. (if known): <input type="text"/> </td> <td> Please specify item no. (if known): <input type="text"/> </td> </tr> </tbody> </table>	Pilot valve	Control Stroke limitation	<input type="checkbox"/> Pilot valve Power supply <input type="text"/>	<input type="checkbox"/> Stroke limitation <input type="checkbox"/> Min./max. stroke with visual position indicator <input type="checkbox"/> Max. stroke without visual position indicator	Please specify item no. (if known): <input type="text"/>	Please specify item no. (if known): <input type="text"/>	
Pilot valve	Control Stroke limitation						
<input type="checkbox"/> Pilot valve Power supply <input type="text"/>	<input type="checkbox"/> Stroke limitation <input type="checkbox"/> Min./max. stroke with visual position indicator <input type="checkbox"/> Max. stroke without visual position indicator						
Please specify item no. (if known): <input type="text"/>	Please specify item no. (if known): <input type="text"/>						
Certifications							
<input type="checkbox"/> Attestation of compliance with the order EN-ISO 10204 2.1 (Item-No. 440 788) <input type="checkbox"/> Test report EN-ISO 10204 2.2 (Item-No. 803 722) <input type="checkbox"/> Certification of Conformity for Raw Material EN-ISO 10204 3.1 <input type="checkbox"/> EN161 (European Gas Device guideline) <input type="checkbox"/> FDA and USP compliance							
Comment / sketch							
<hr/> <hr/> <hr/> <hr/> <hr/> <hr/>							

DTS 1000097547 EN Version: J Status: RL (released | freigegeben | valide) printed: 20.01.2015

To find your nearest Bürkert office, click on the orange box →

www.burkert.com